

REV.	SPECIFICATION	ECN NO.	APPD.
R6		ECR210723	

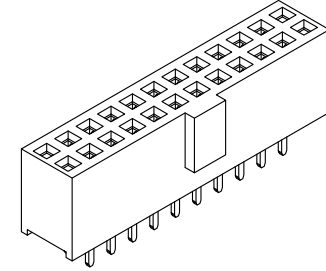
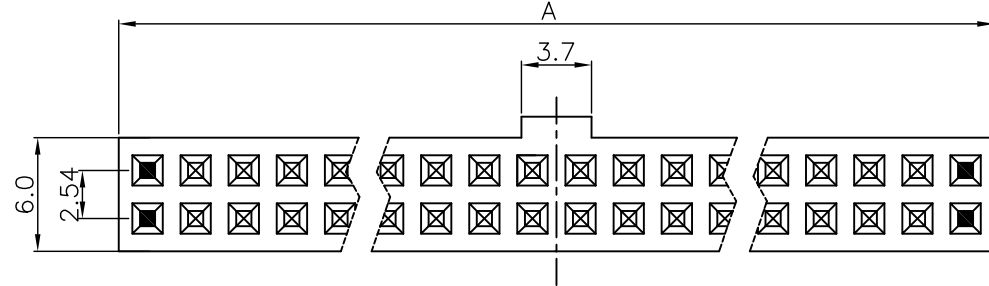

Material and Plating:
Housing: PBT, UL94V-0, Black.
Contacts: Brass.
Gold Plated or 80u" Min Tin on Contact Area and 80u" Min Tin or Gold Flash Plated on solder tail over 50u" Min Nickel.

Electrical Characteristics:
Current Rating: 2 AMP.
Dielectric Withstanding Voltage : AC 1000V For 1 minute.
Insulator Resistance: 1000MΩ min. at DC 500V.
Contact Resistance: 20mΩ max. at DC 100mA.
Operating Temperature: -55°C ~+105°C .

***RoHS Compliant**
Insertion Depth: 2.55mm to 5.70mm.

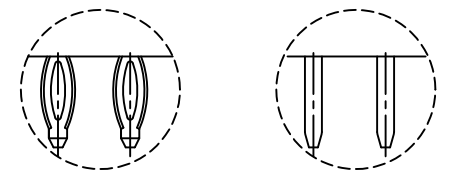

Press Fit Dip Type

Detail A

**Available Position						
	Pos.	Dimension			Dimension	
		A	B		A	B
*	6	12.70	10.16		36	50.80
*	8	15.24	12.70		38	53.34
*	10	17.78	15.24	*	40	55.88
	12	20.32	17.78		42	58.42
*	14	22.86	20.32	*	44	60.96
*	16	25.40	22.86		46	63.50
*	18	27.94	25.40	*	48	66.04
*	20	30.48	27.94	*	50	68.58
	22	33.02	30.48		52	71.12
*	24	35.56	33.02		54	73.66
*	26	38.10	35.56		56	76.20
	28	40.64	38.10		58	78.74
*	30	43.18	40.64	*	60	81.28
	32	45.72	43.18		62	83.82
*	34	48.26	45.72	*	64	86.36

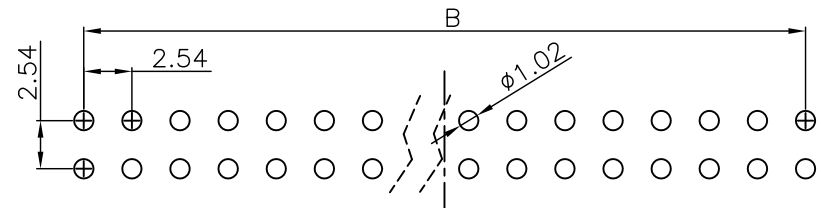
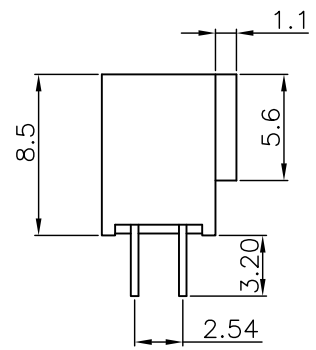
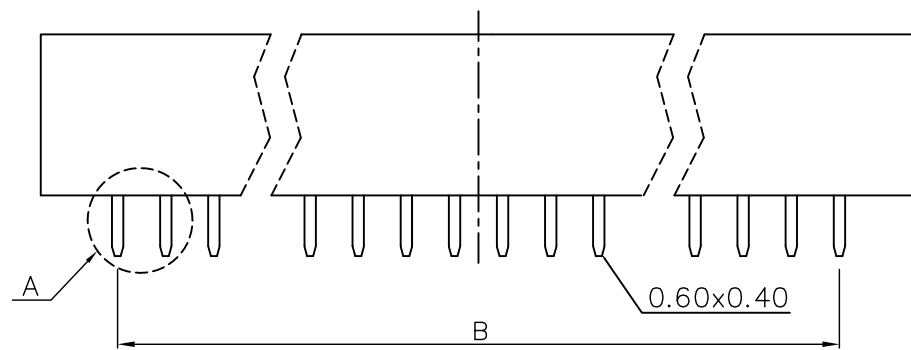

P.C. Board Layout
(Tolerance:±0.05)

2046- xx G xx S x A

Series: A: Tray Package, B: Bulk Package
No. of Contacts: G: Gold Plated, T: Tin Plated
P: Press Fit Type, S: Straight
00: G/F, 10: 10μ", 15: 15μ", 30: 30μ"

Tolerances	Dwg. No.	2046-D0000-001	Title:	2046 Series	
x = ±0.5	Projection		P.C.B. Socket 2.54mmX2.54mm		
.x = ±0.25	Unit	mm	Scale		1:1
.xx = ±0.15	Drawn By	WP 07/19'21	(0.100"X0.100")		

OUPIIN			
OUPIIN ELECTRONIC(KUNSHAN) CO., LTD.			
P/N: 2046-xxGxxSxA			
SHEET	1/1	Ver.No.	R6